

ALCOVE HINGE SHOWER SERIES

INLINE - 2 PANELS

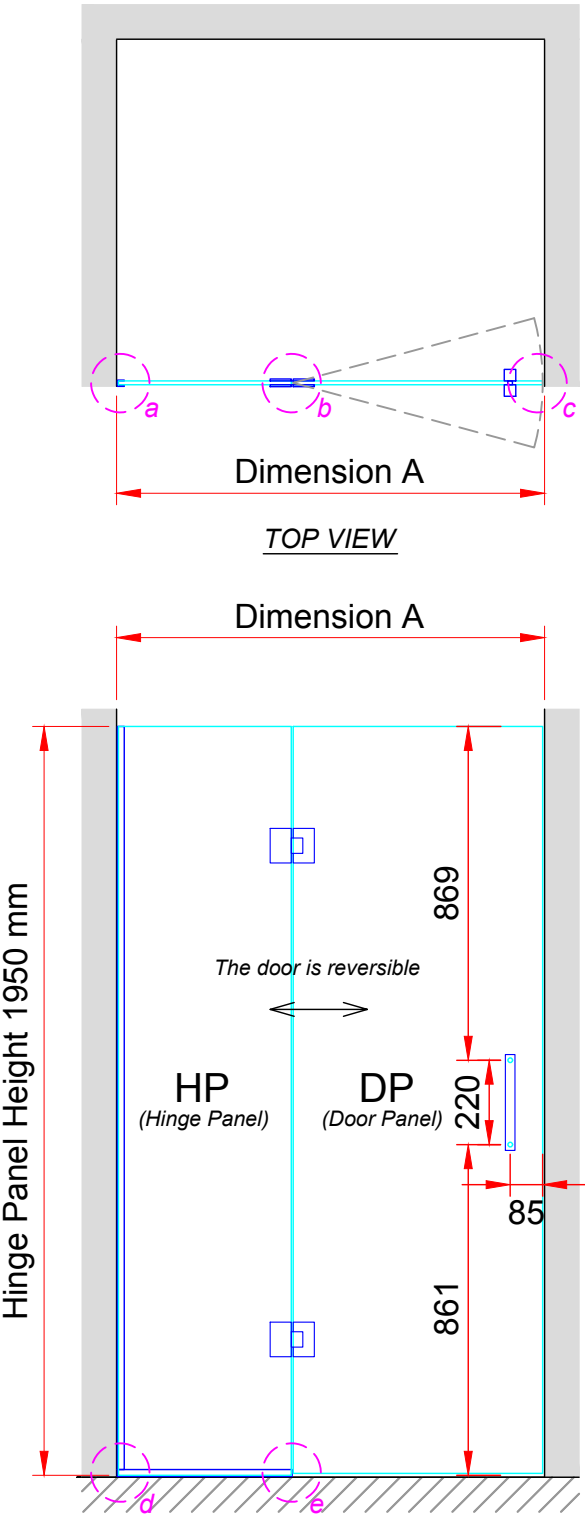

INLINE - 3 PANELS

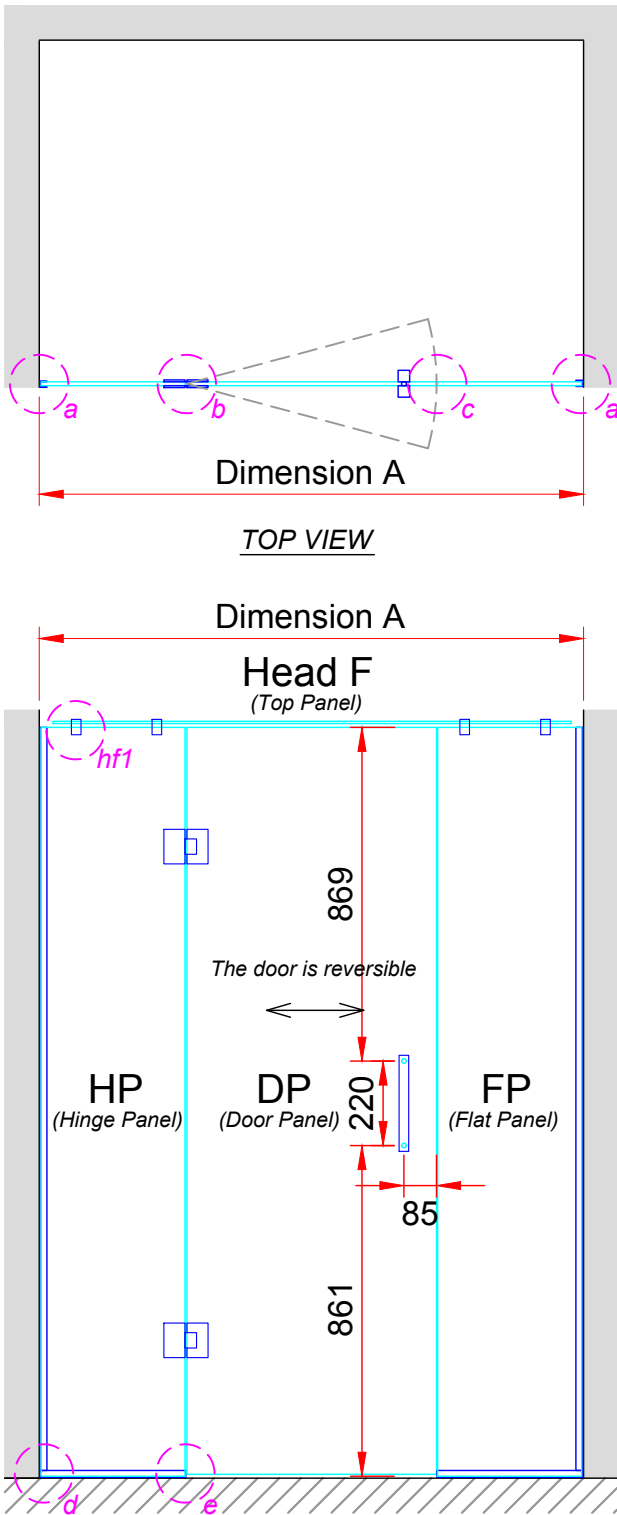

Important:

Before you install your project, please read this installation guide carefully, consider the gap between each part, calculate the exact length before cutting.

The corners and edges of toughened glass are its weakest points, so ensure they are well-protected during installation.

Always use rubber spacers to separate stainless steel hardware from the glass to avoid damage.

After completing the installation, it is essential to clean both the glass and the hardware. Proper cleaning of the glass helps maintain its protective coating, and cleaning the hardware removes any metal debris from the installation process, preventing potential rust.

Additionally, regular cleaning afterward is recommended to ensure long-term durability and maintain optimal performance.

LEGEND

Dimension A	The overall dimension including gaps between wall and all glass panels (±1mm to all gaps recommended).
Dimension B	The overall depth including gaps between wall and return panel (±1mm to all gaps recommended).
FP	Flat Panel
DP	Door Panel
HP	Hinge Panel
HEAD F	Head Flat Panel
a	Wall, channel, rubber and glass panel fixing detail
b	Gap between door and hinge panel
c	Gap of door on handle side
d	Floor channel and wall channel joint
e	Gap between door and floor
f	Gap between door and return panel
g	Flat panel 90° joint
hf1	Head panel clamp layout 1
hf2	Head panel clamp layout 2
hf3	Head panel clamp layout 3

For more detailed information, please contact the team: email sales@grandglass.co.nz ph 09 478 9778 or 027 755 7705 www.grandglass.co.nz



ADD: 18a Parkway Drive, Rosedale. PH: 09 478 9778 , 027 755 7705

Grand Glass Hinge Shower Installation Guide

Complies with NZS3604:2011

Drawn By : SW	Date : 1/22/2025	Paper Size : A3
Checked By : JQ		Scale : NTS
Drawing No. : GGH-RS01		Rev. No. : 0
		Sht. No. : 1

RECTANGLE HINGE SHOWER SERIES

RECTANGLE - 3 PANELS

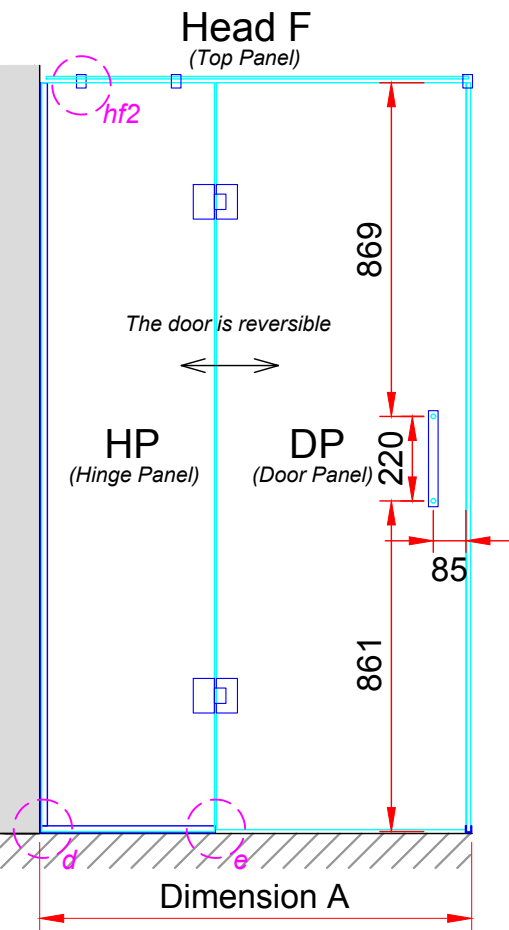
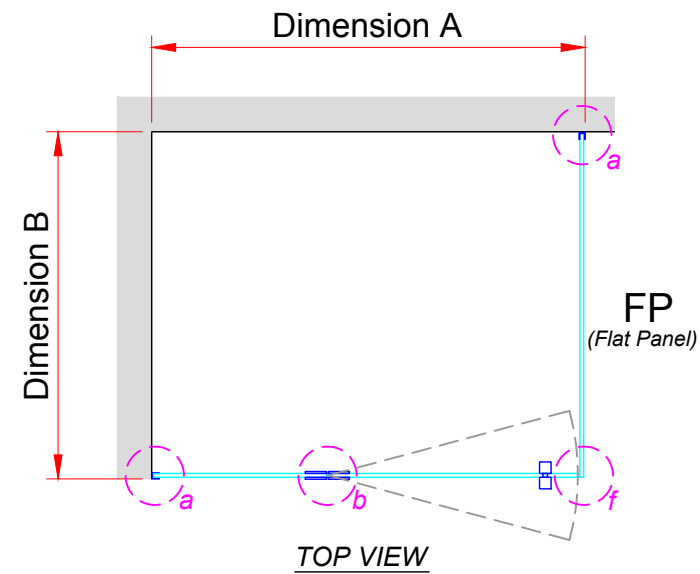

RECTANGLE - 4 PANELS

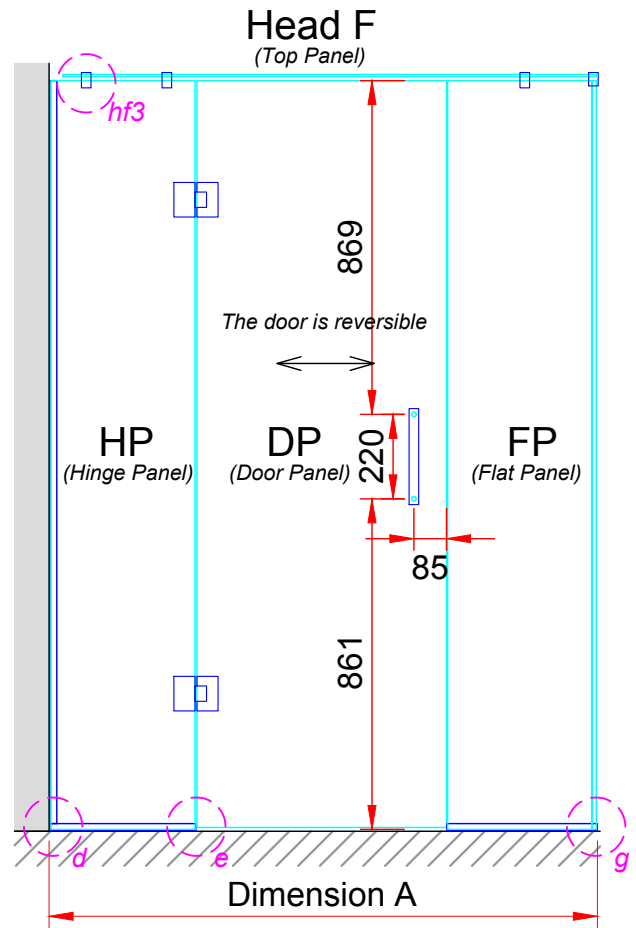
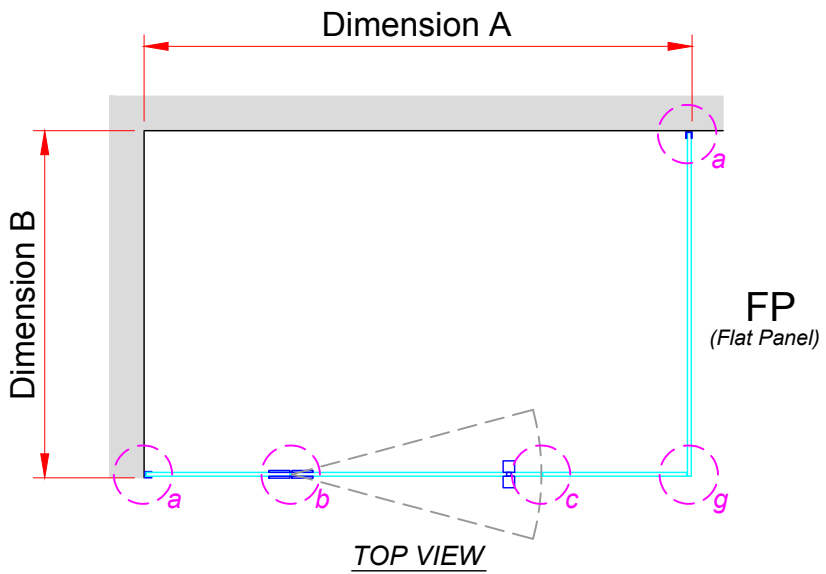

FIXING DETAIL

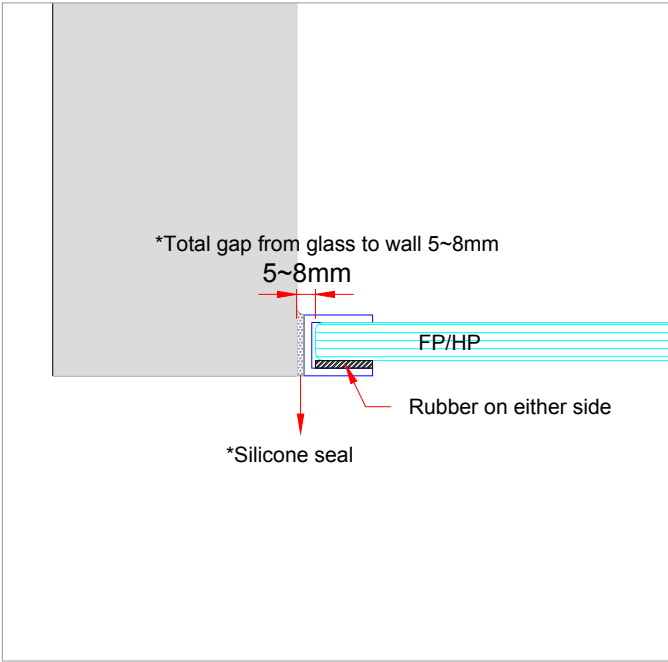

FIXING DETAIL a

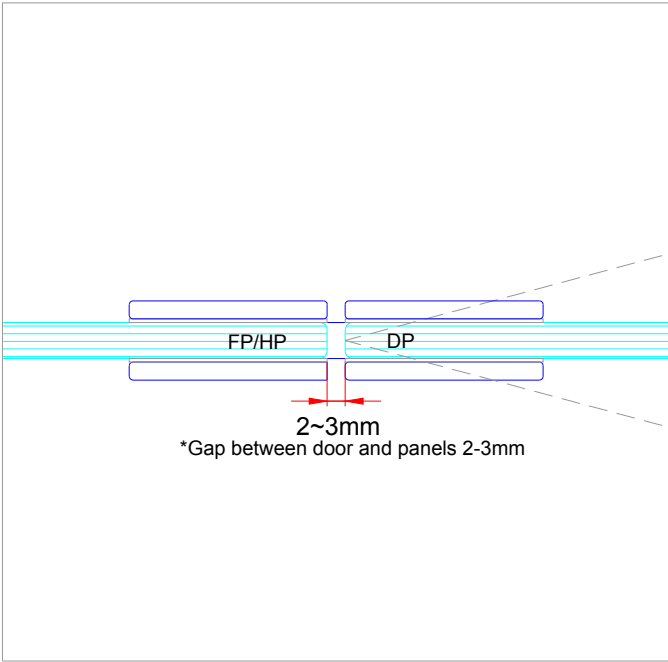

FIXING DETAIL b

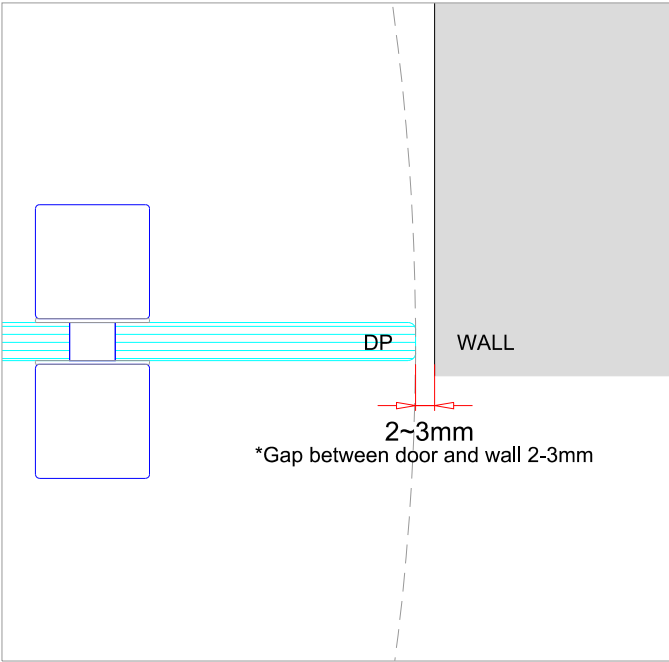

FIXING DETAIL c

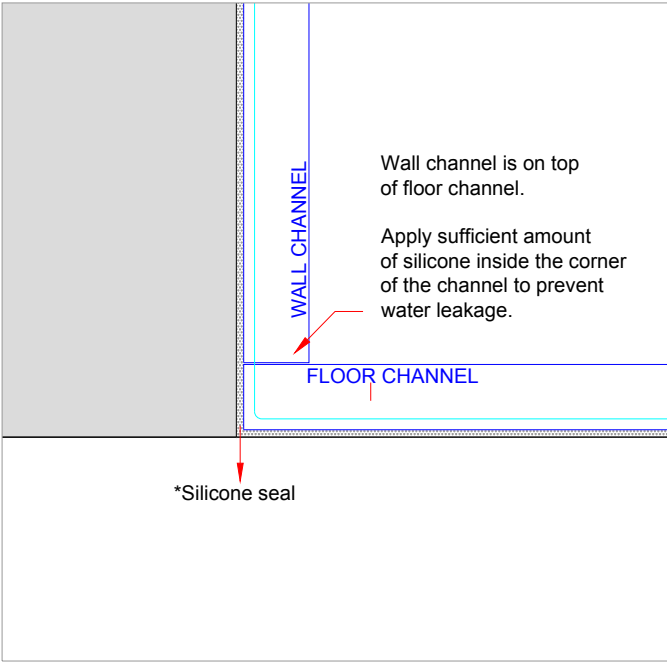

FIXING DETAIL d

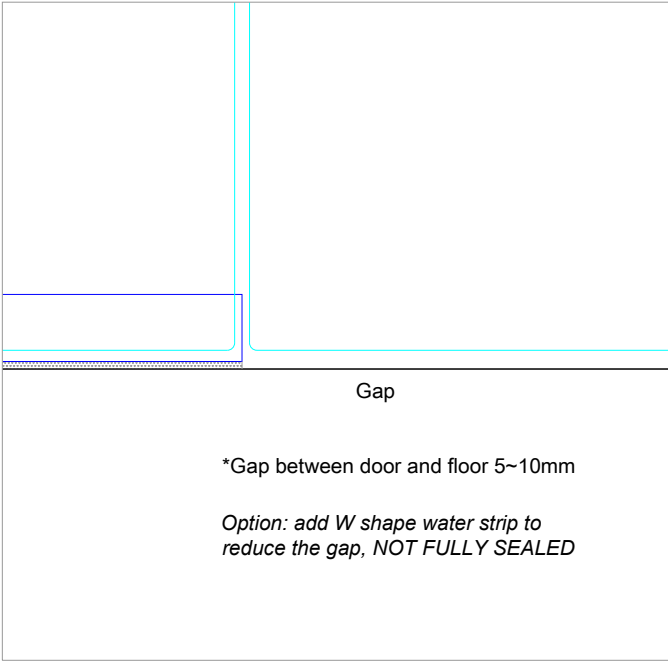

FIXING DETAIL e

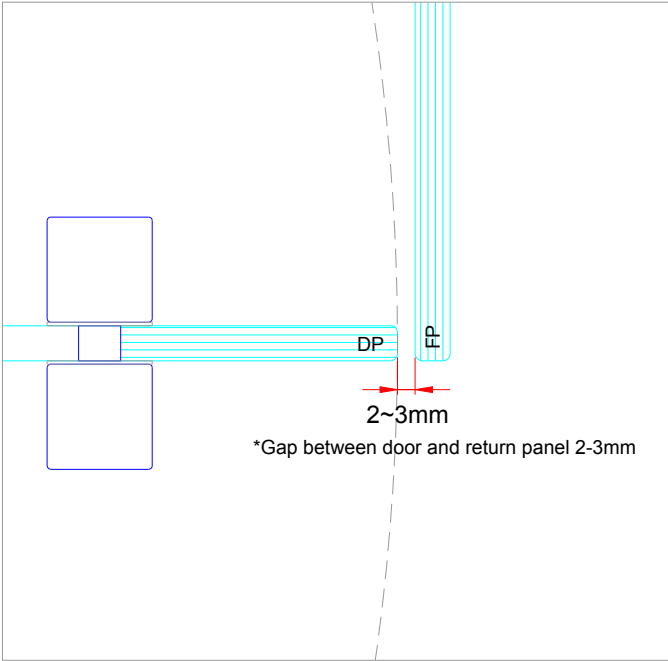

FIXING DETAIL f

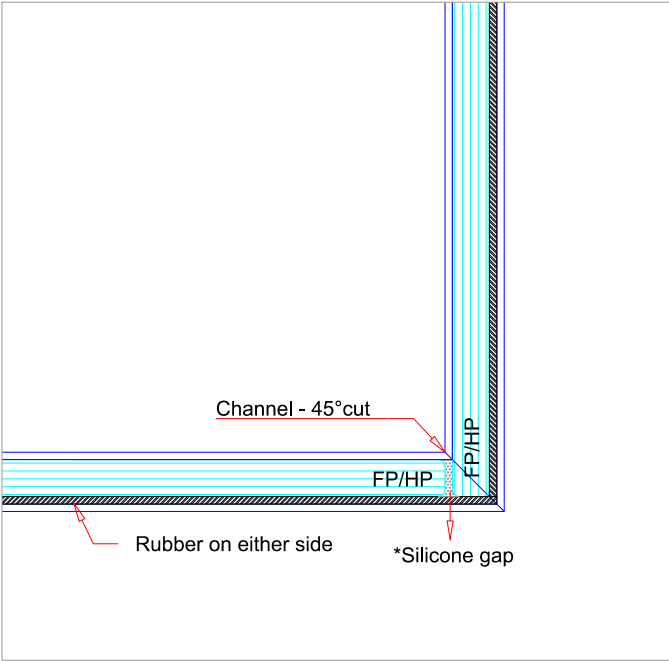

FIXING DETAIL g

FIXING DETAIL - HEAD PANEL

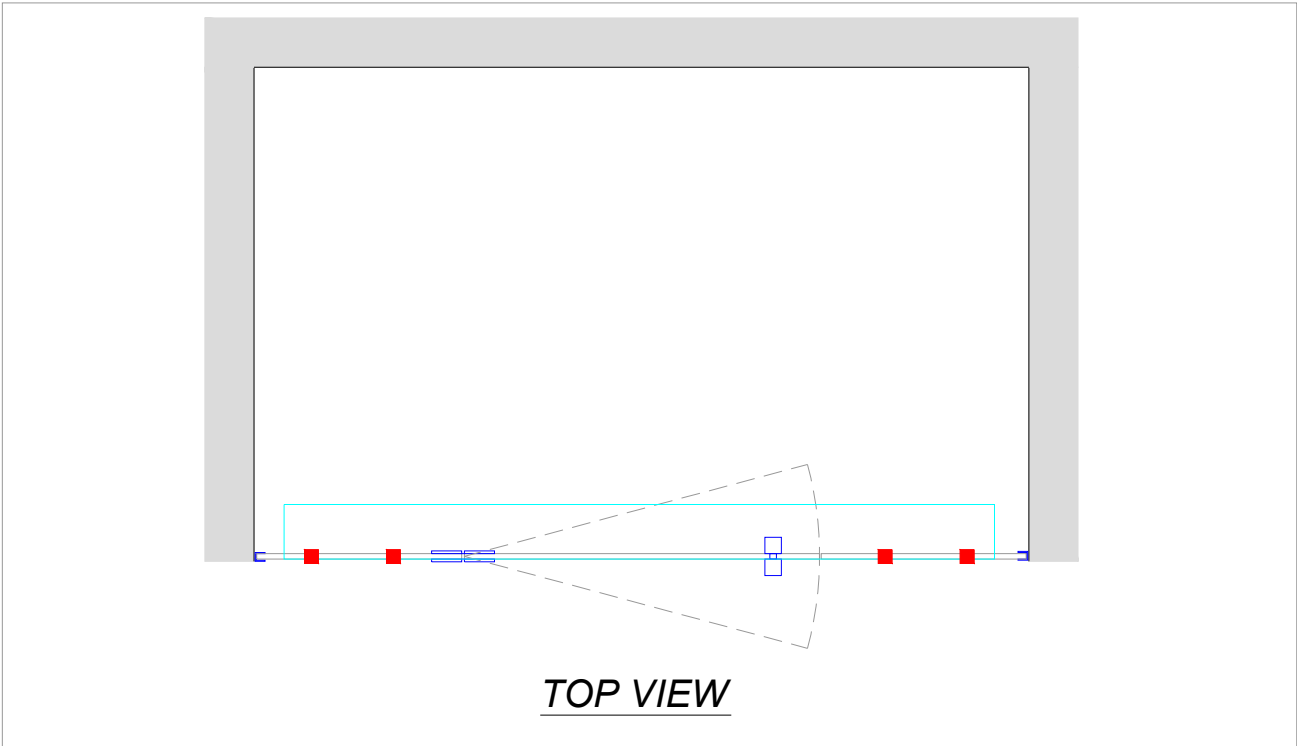

FIXING DETAIL hf1

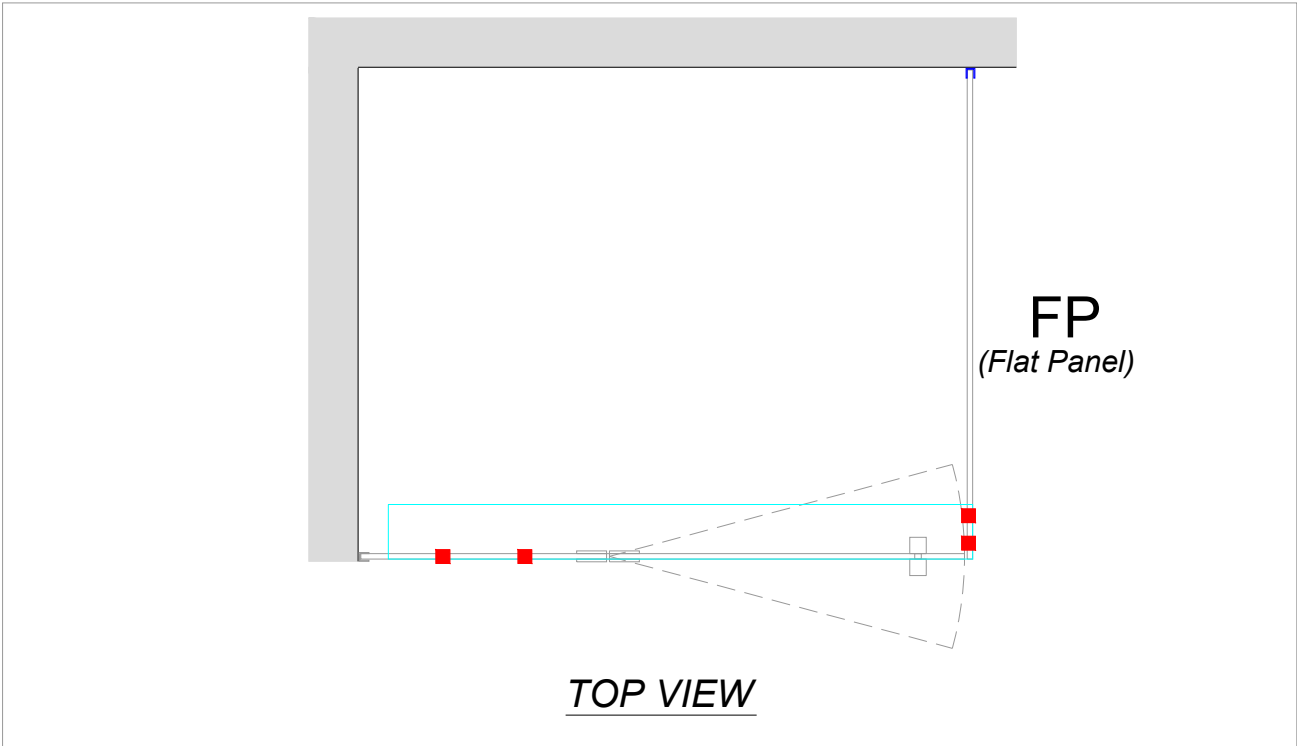

FIXING DETAIL hf2

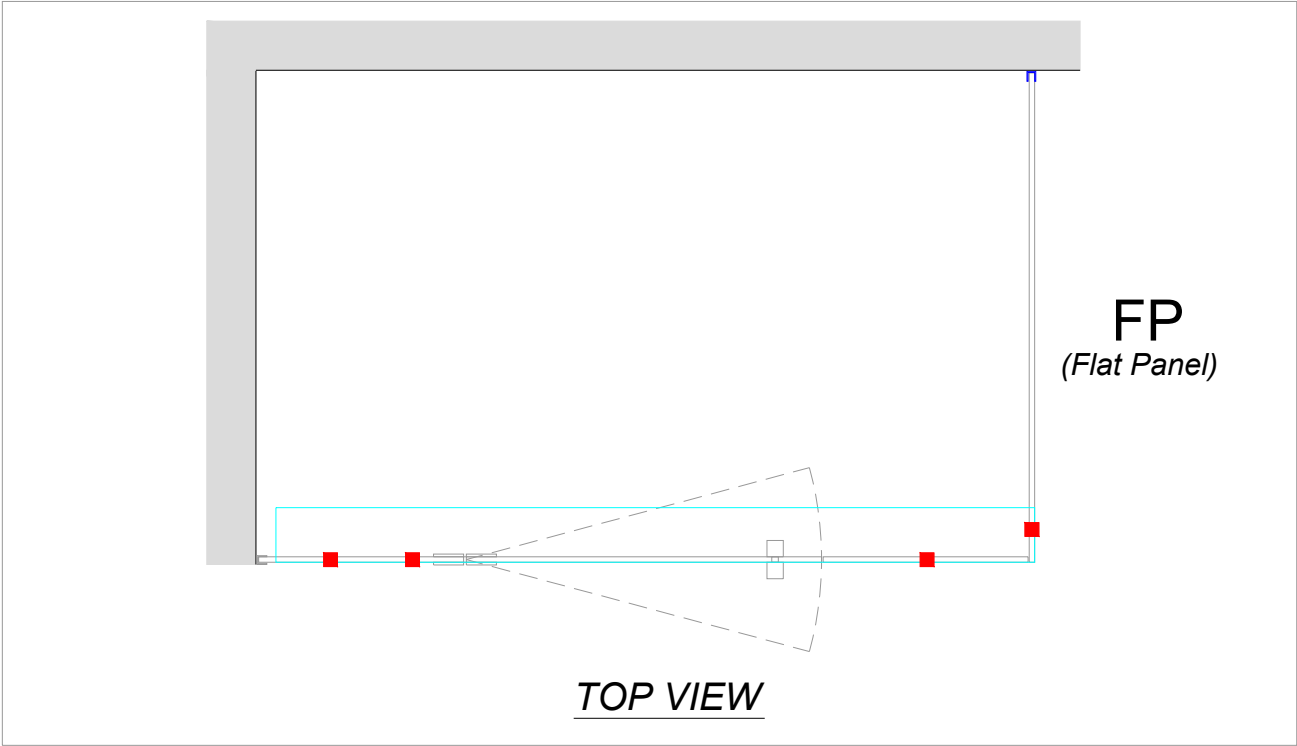

FIXING DETAIL hf3

■ HEAD PANEL CLIP